

AirSeal® Air Door by Enviro®

Single Horizontal Recirculatory Air
Cooler/Freezer Pallet Conveyor Style Door

Data Sheet

Model 615

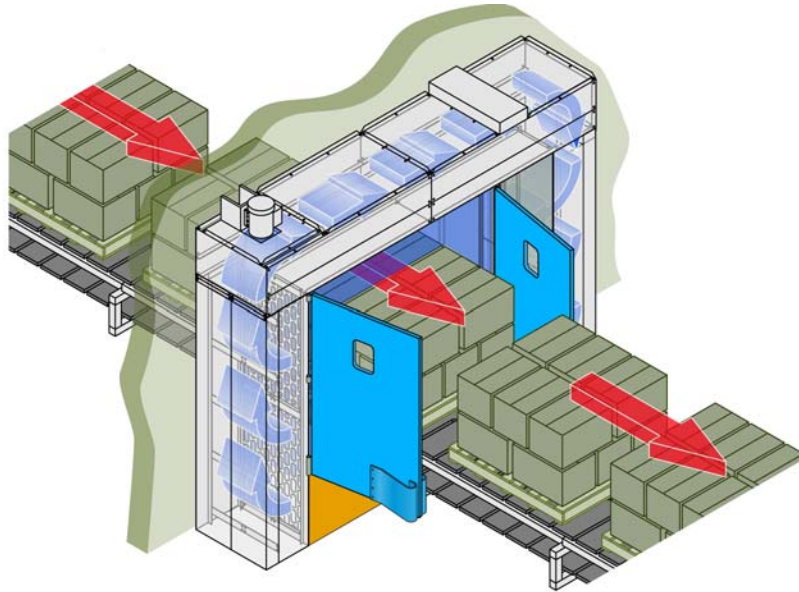

FEATURES

- AirSeal's invisible barrier allows for unobstructed pallet flow with minimal loss of refrigeration and/or heat gain.
- Significantly reduces fog, ice and moisture associated with wide-open doorways.
- Adjustable and programmable air speed controls, allowing for precise application settings.
- Integrated self-regulating EPLC controlled heater unit for optimal air mixing temperature control and condensation reduction.
- AirSeal's efficiency reduces coil defrosting burden and improves refrigeration cycle efficiency.
- Electric or hot gas heat reclaim allows for precise application requirements.
- Eliminates maintenance costs associated with hard panel doors.
- No need for energy absorbing infrared heat lamps.
- Reduction of ice, fog and moisture dramatically increases safety and material handling.
- Fully programmable logic controller with preset modes for maximum energy cost savings.
- All galvanized or stainless steel design for cleanability.



Model 615

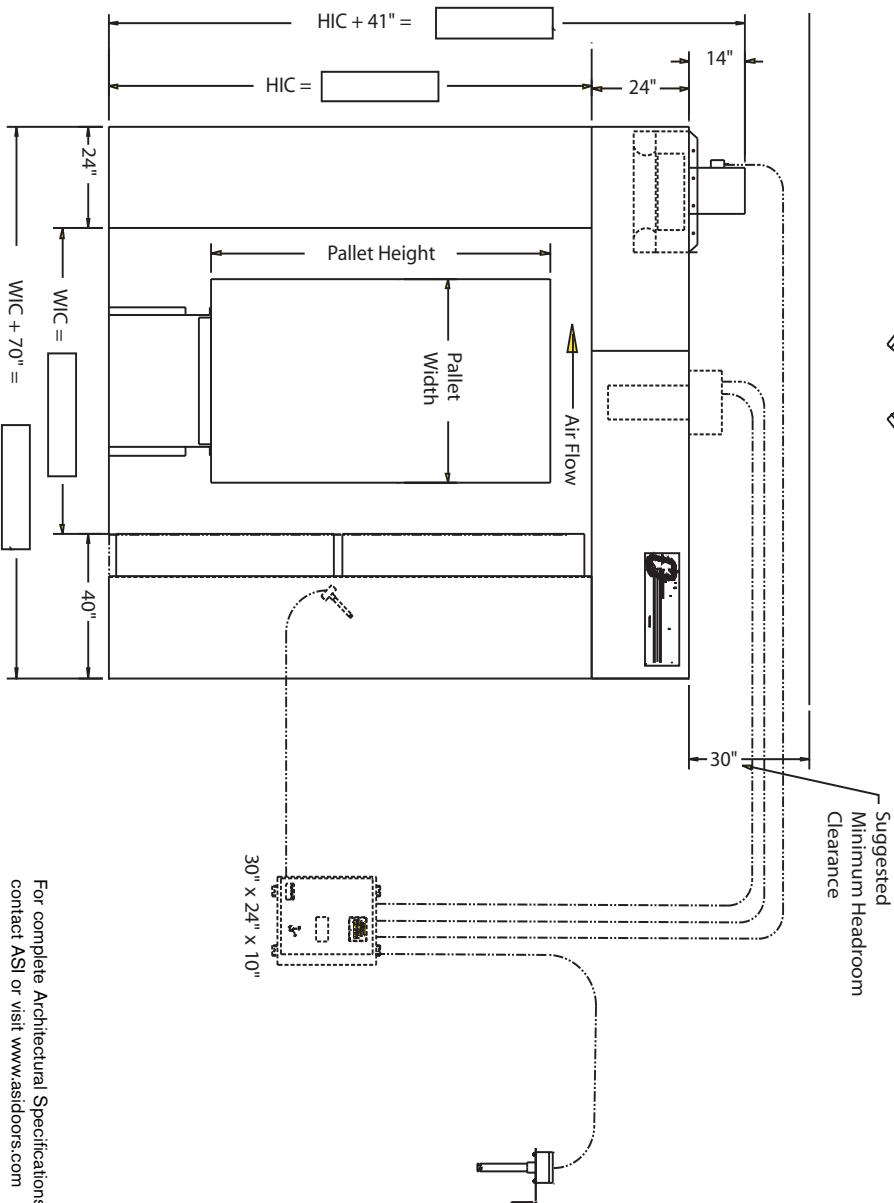
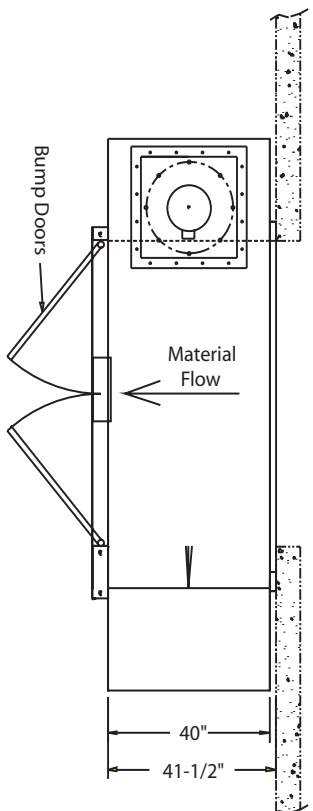

*Patent Pending

For complete Architectural Specifications contact ASI or visit www.asidoors.com

DESIGN AND CONSTRUCTION
(Door designed for conveyor pallet traffic.)

DOOR SIZES

- Maximum: 10'0" x 15'0".
- Minimum: 6'0" x 6'0".
(Other sizes available - Consult factory)

CONSTRUCTION

- Galvanized metal.
- Stainless steel.

OPERATION

- Electric operation:
- AirSeal® - 4,600 cfm at 4" of water gauge.

OPERATOR

- High efficiency low noise direct driven operator with 5 h.p. motor.

ELECTRICAL FEATURES

- NEMA-4 control enclosure.
- Fully programmable EPLC controls.
- Variable frequency drive.
- Optimization Controls (Freezer door).

WARRANTY

- One year limited warranty on all components.

OPTIONS

- Electric or hot gas heat reclaim.
- Manual power sliding insulated cooler/freezer door.
- Digital display on cooler door.
- Interlock to existing door.
- Stainless steel construction.
- High speed fabric roll-up door.
- Insulated bump door.
- PVC strips.
- Vertical air flow *(consult factory)*.

ASI
Technologies, Inc.



61 BDS 1/2005

5848 N. 95th Court • Milwaukee, WI 53225 • (414) 464-6200 • (800) 558-7068 • FAX: (414) 464-9863 • www.asidoors.com
Consistent with our policy of continued product improvement, we reserve the right to change product specifications without notice or obligation.

©2004, ASI TECHNOLOGIES, INC. • PRINTED IN U.S.A.